

COTIC

HOW TO: FIT A CASCADE FRAME BAG

01 | YOUR FRAME BAG IS MADE UP OF AN OUTER WATER REPELLENT BAG AND AN INNER WATERPROOF BAG.

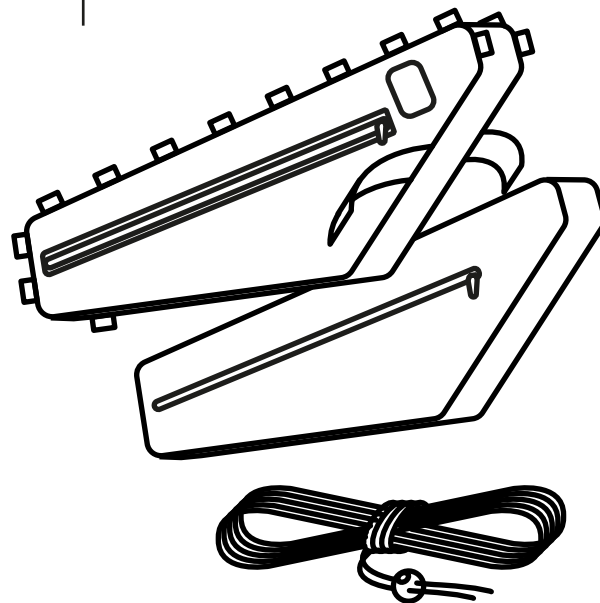

02 | FIT THE INNER BAG INSIDE THE OUTER BAG. FILL THE BAG WITH SOMETHING SOFT AND LIGHTWEIGHT, THIS WILL PAD THE BAG OUT AND HELP WITH FITTING TO THE FRAME.

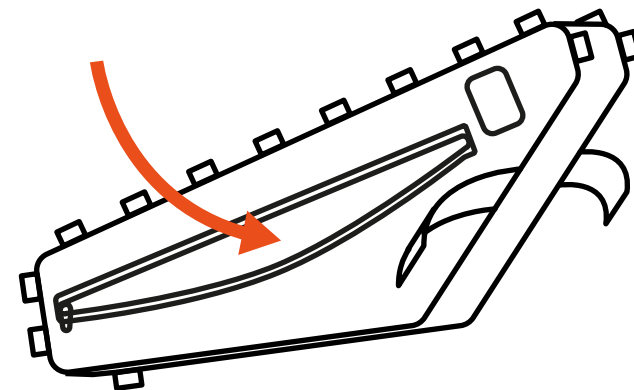

03 | OFFER UP THE FRAME BAG TO THE FRAME, MAKING SURE TO PUSH IT UP INTO THE TOP OF THE TRIANGLE SO IT IS CLOSE TO THE HEAD TUBE. WRAP THE VELCRO STRAPS AROUND THE DOWNTUBE.

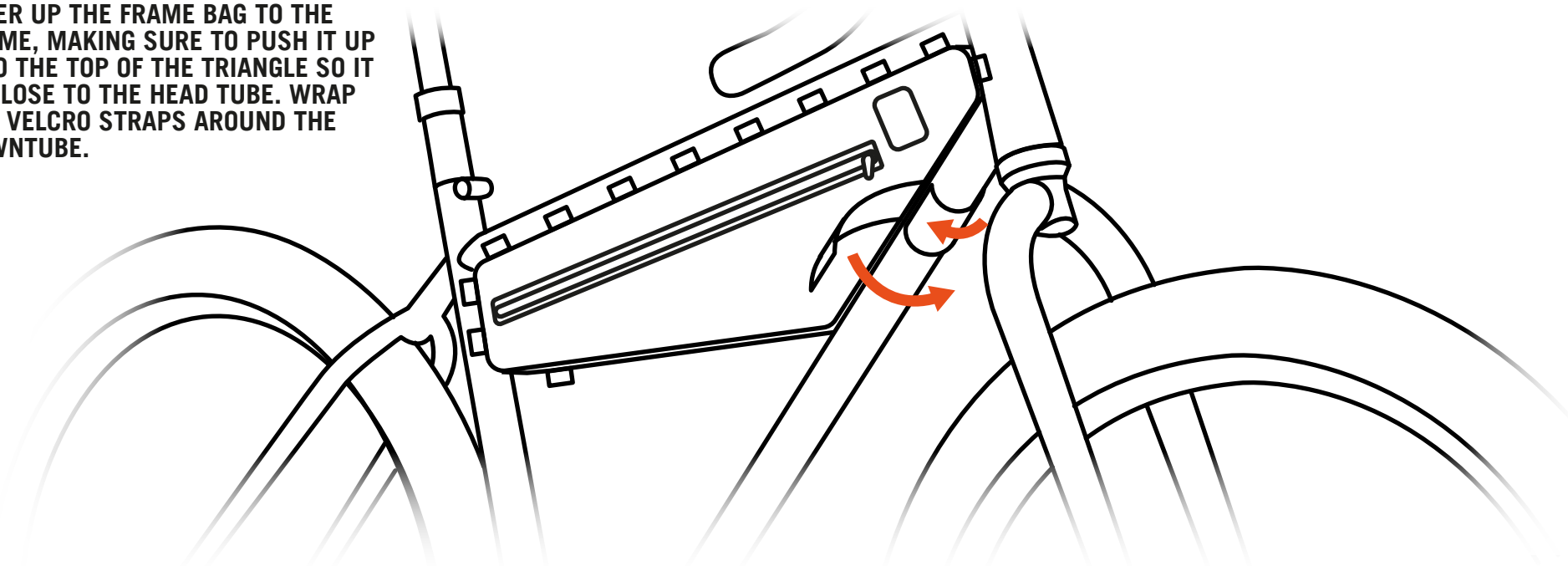

04

FEED THE CORD THROUGH THE TWO FRONT TABS OF THE FRAME BAG. AT THIS POINT CHECK THE CORD IS THE SAME LENGTH EITHER SIDE.

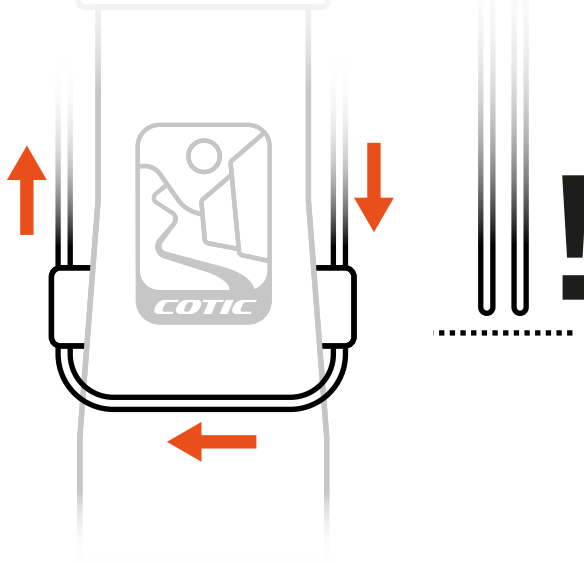

05

CROSS THE CORD OVER EACH OTHER IN FRONT OF THE HEAD TUBE.

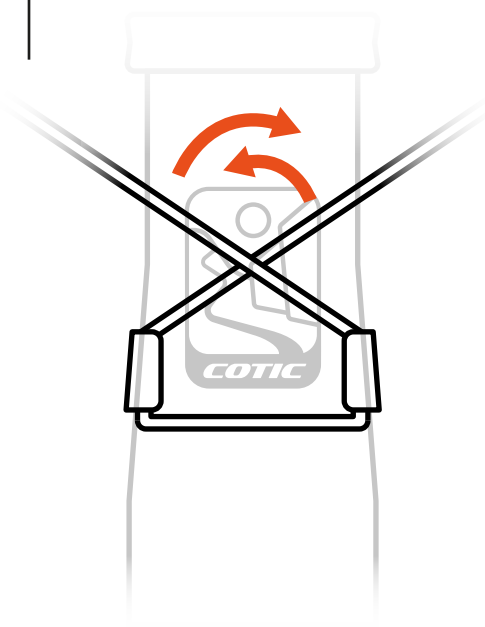

06

WRAP THE CORD AROUND THE HEAD TUBE MAKING SURE IT IS ABOVE THE TOP TUBE.

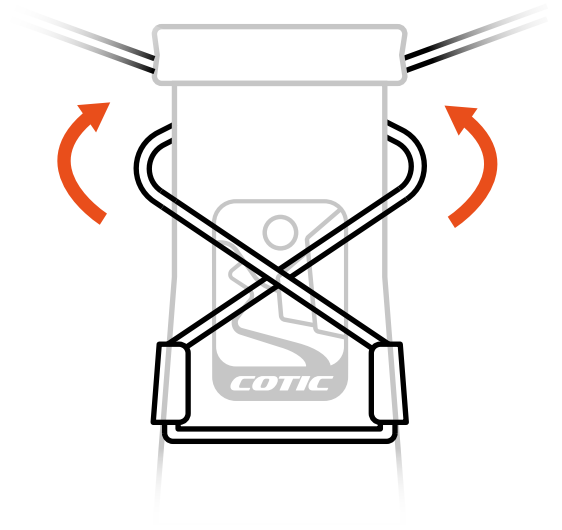

07

A. CROSS OVER THE CORDS OVER BEHIND THE HEADTUBE. FEED THE CORDS THROUGH THE FIRST TWO TOP TABS ON THE FRAME BAG.

B. LACE UP THE REMAINING TABS ALONG THE FRAME BAG AS YOU WOULD A PAIR OF SHOES. WHEN AT THE LAST PAIR OF TABS NEAREST THE SEAT TUBE, GO ALONG ALL THE CORD/TABS TO CHECK THEY'RE TAUGHT.

C. BEHIND THE LAST TWO TABS ON THE TOP OF THE FRAME BAG, DO NOT CROSS THEM OVER BEFORE THE SEAT TUBE.

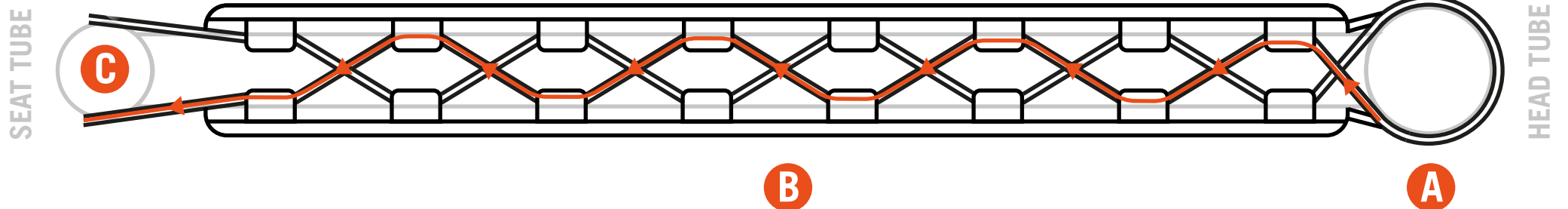

- A.** CROSS THE CORDS OVER BEHIND THE SEAT TUBE. (ILLUSTRATION ONLY SHOWS ONE CORD BEING LACED, MIRROR THESE STEPS FOR THE OPPOSITE CORD).
- B.** FEED THE CORD THROUGH THE TOP TAB ON THE BACK OF THE BAG.
- C.** WRAP AROUND THE BACK OF THE SEAT TUBE.
- D.** FEED THE CORD THROUGH THE BOTTOM TAB ON THE BACK OF THE BAG.
- E.** WRAP BACK AROUND THE SEAT TUBE.
- F.** FEED THE CORD THROUGH THE SINGLE TAB ON THE UNDERSIDE OF THE FRAME BAG. AT THIS STAGE, GO BACK TO THE TABS/CORD YOU HAVE JUST LACED UP AND CHECK THEY ARE TAUGHT AND SYMMETRICAL. FIT THE TOGGLE TO THE ENDS OF THE CORD. PULL THE ENDS OF THE CORD TIGHT AND CHECK THERE IS NO LOOSE CORD AROUND THE FRAME BAG. FINALLY SLIDE THE TOGGLE UP AGAINST THE TAB.

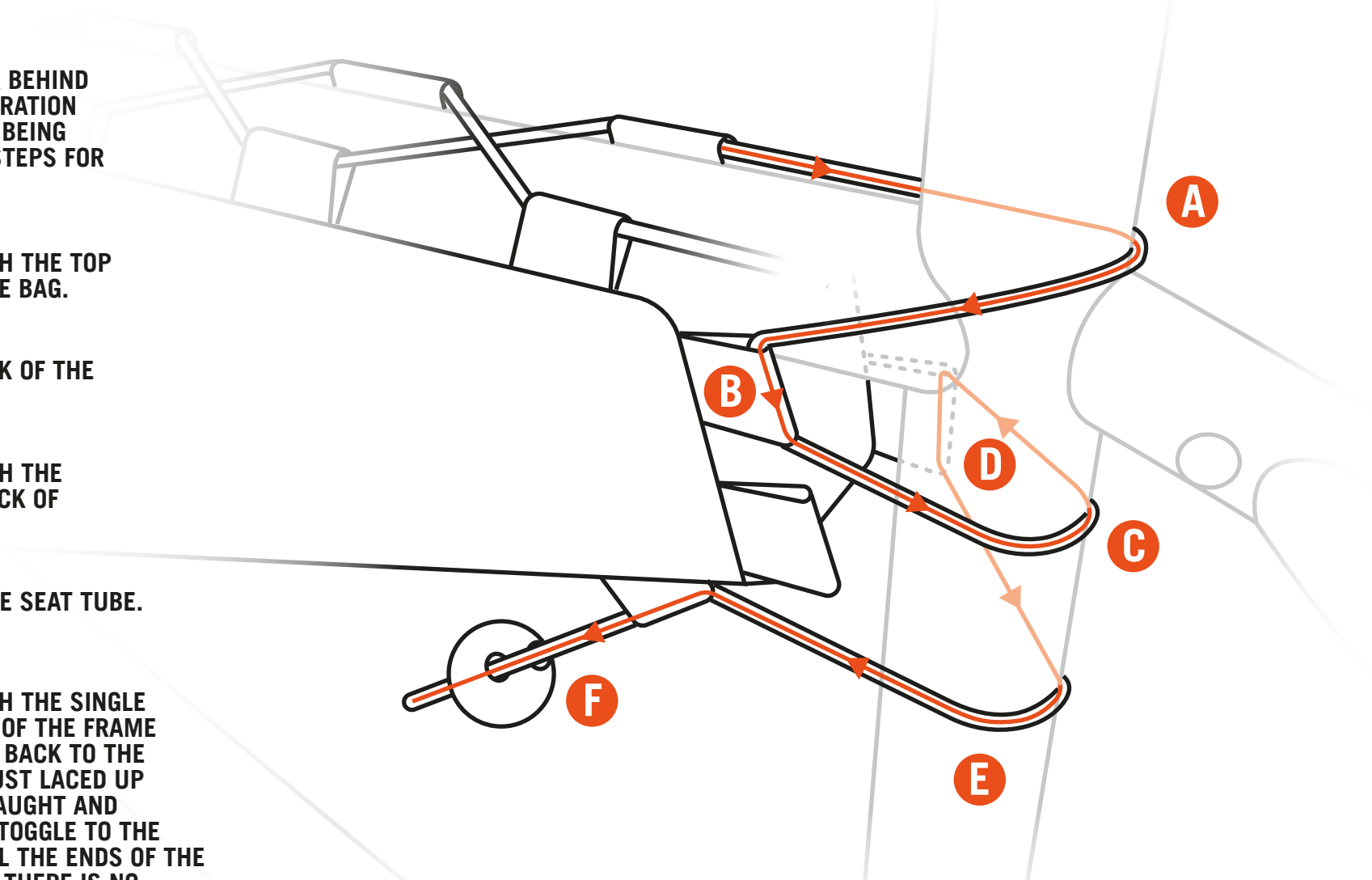

YOU MAY FIND THE CORD IS A LITTLE LONGER THAN YOU NEED, YOU CAN EITHER TRIM IT TO SIZE OR SIMPLY KNOT IT TO KEEP IT OUT OF THE WAY.